

Biddisham Lane, Axbridge

Guide Price £610,000

4 2 3



EXCELLENT DETACHED FAMILY HOME - with superior proportions. This large four/five bedroom family home is perfectly positioned for a rural lifestyle within easy reach of Taunton and Bristol and just a short drive into Axbridge.



Key Features

- Executive detached family house
- Two bathrooms, one ensuite
- Spacious accommodation throughout
- Scope to extend (subject to planning permission)
- Garage and large driveway with parking for several cars
- Four Double bedrooms plus a study/bedroom
- Two large reception rooms and conservatory
- Utility room and downstairs clockroom
- 140ft West facing garden
- EPC D

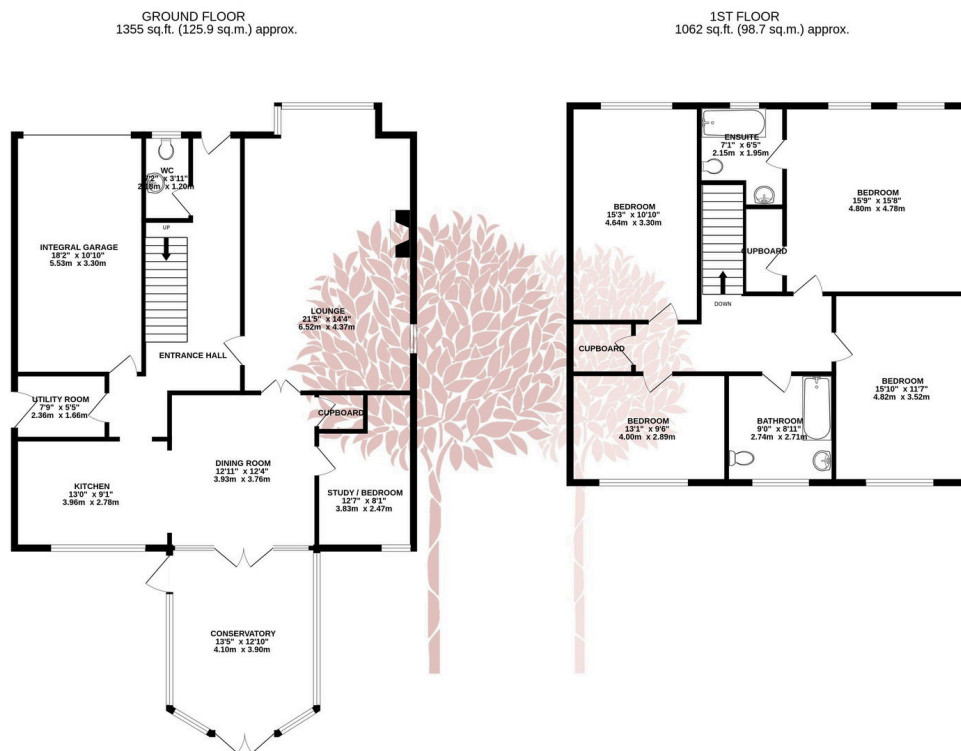

TOTAL FLOOR AREA: 2417 sq.ft. (224.6 sq.m.) approx.

Whilst every attempt has been made to ensure the accuracy of the floorplan contained here, measurements of doors, windows, rooms and any other items are approximate and no responsibility is taken for any error, omission or mis-statement. This plan is for illustrative purposes only and should be used as such by any prospective purchaser. The services, systems and appliances shown have not been tested and no guarantee as to their operability or efficiency can be given.

Made with Metropix ©2024

